



## Gillies Lake

Township of Lanark Highlands (Lanark)

Surface Area: 54 acres

### Directions:

Located East of Herron Mills and South of Herron Mills Road (County Road #8). Gillies lake is situated at Lot 9, Concessions 4 and 5, geographic Township of Lanark, now in Lanark Highlands. Surrounded by private land. There is no public access.

### Fish

- Brown Bullhead
- Ling
- Northern Pike
- Perch
- Rock Bass
- Walleye
- White Sucker

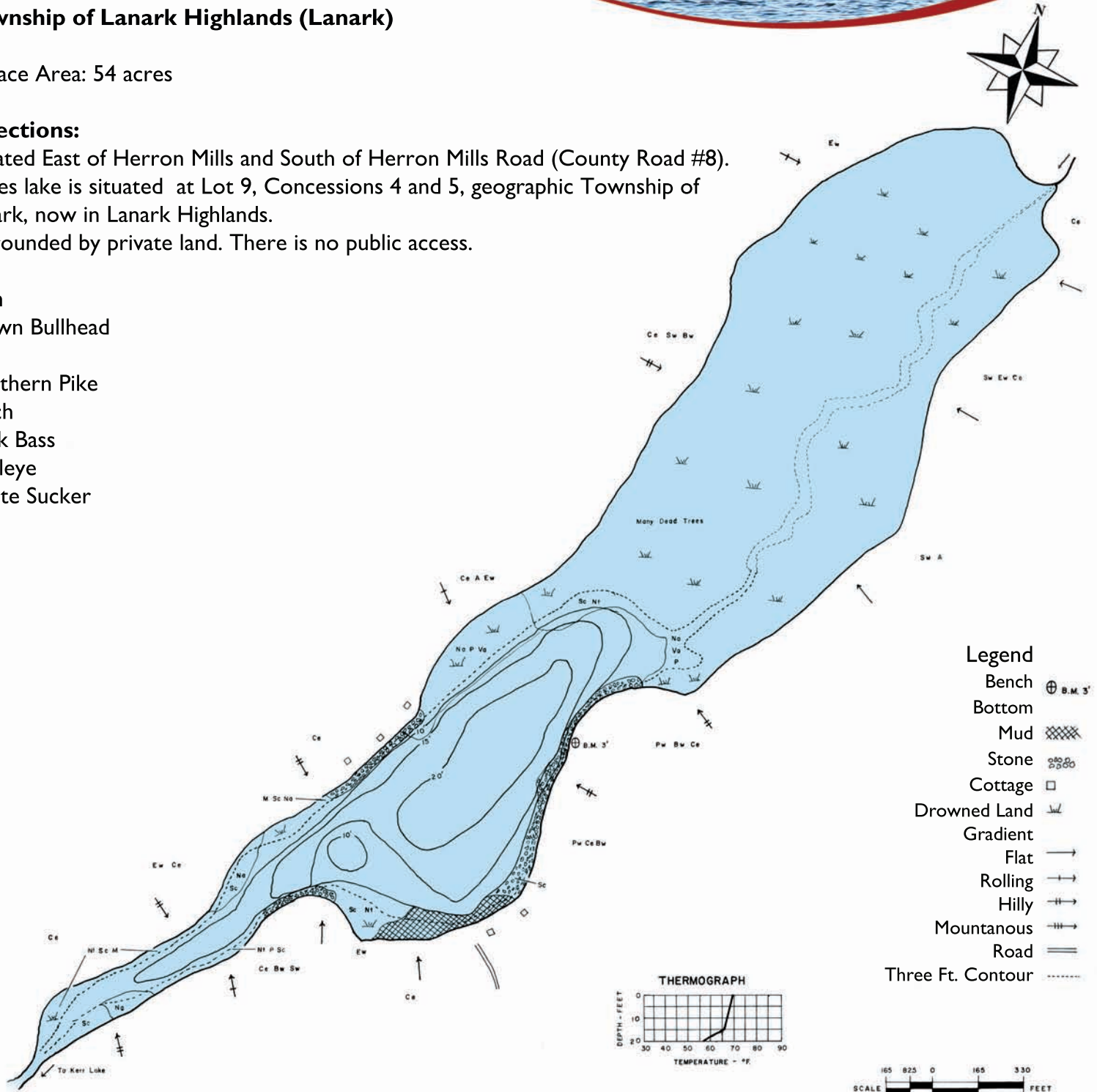

- Legend**
- Bench
  - Bottom
  - Mud
  - Stone
  - Cottage
  - Drowned Land
  - Gradient
  - Flat
  - Rolling
  - Hilly
  - Mountainous
  - Road
  - Three Ft. Contour

This map is intended for fisheries management purposes only. It should not be used as a guide in navigation because no effort has been made to show the various schools and hazards which might occur between points of sounding.